

SUFFOLK COUNTY SHELLFISH AQUACULTURE LEASE PROGRAM IN PECONIC BAY AND GARDINERS BAY - TEN YEAR REVIEW

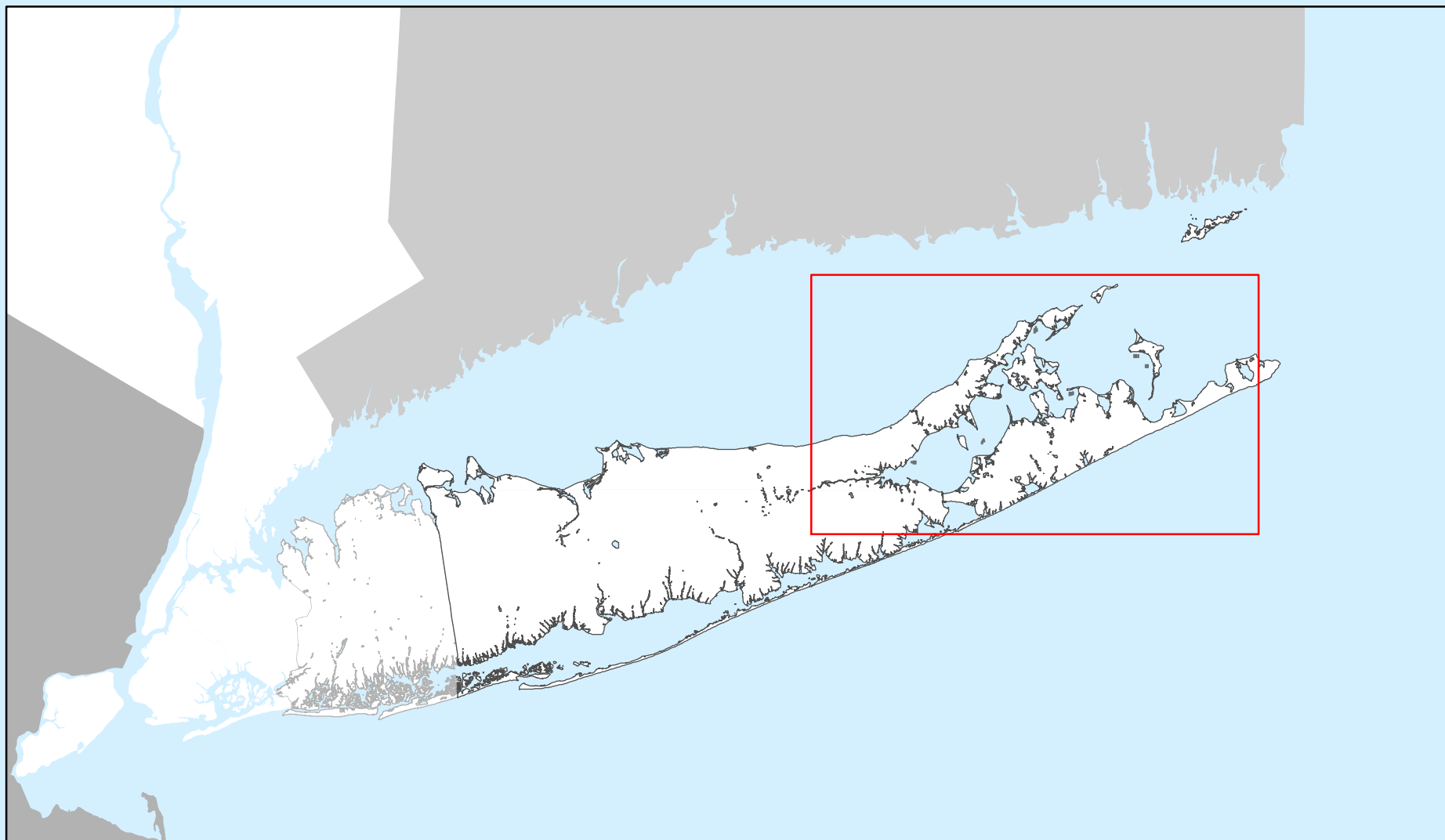

LOCATOR MAP

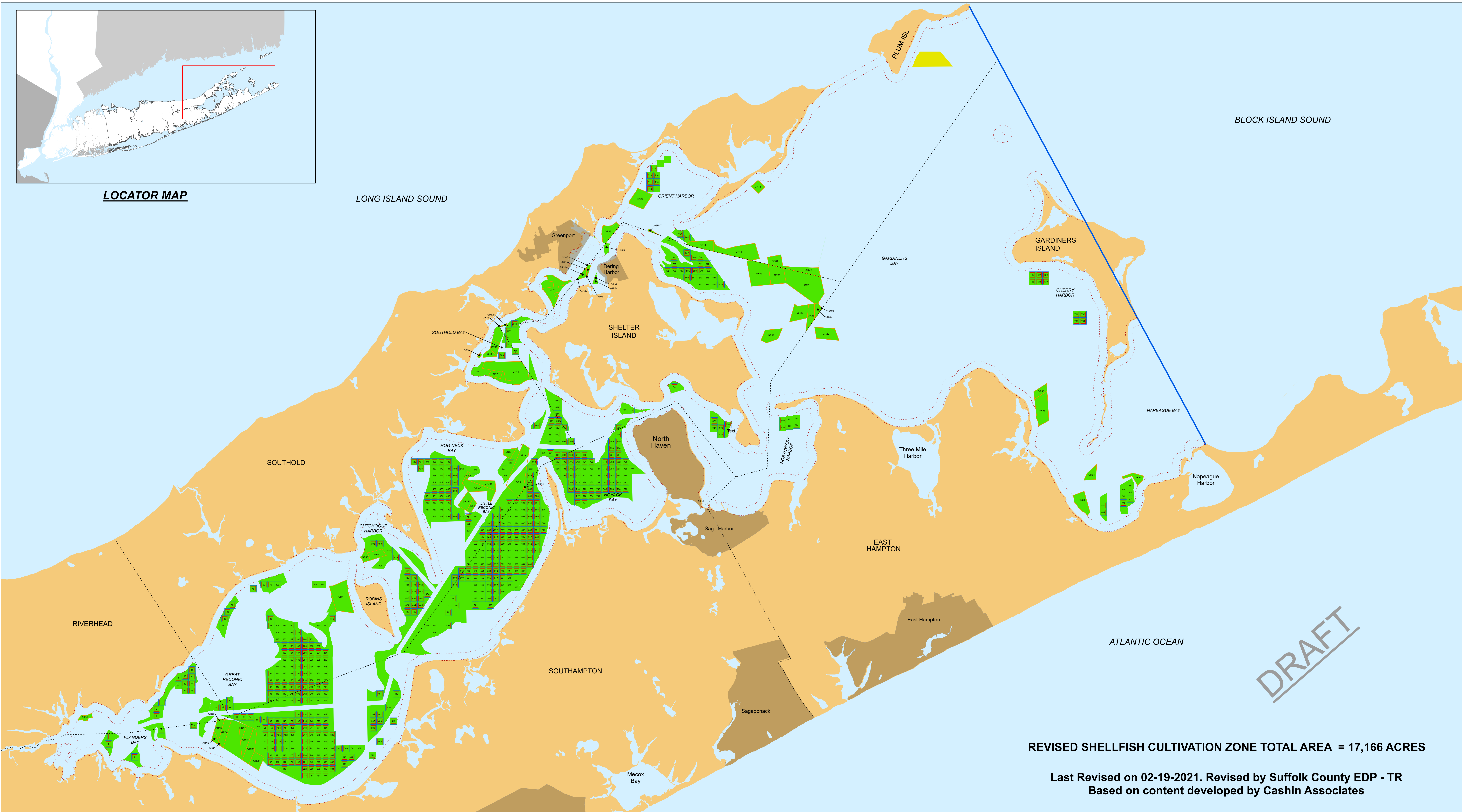

DRAFT

REVISED SHELLFISH CULTIVATION ZONE TOTAL AREA = 17,166 ACRES

**Last Revised on 02-19-2021. Revised by Suffolk County EDP - TR
Based on content developed by Cashin Associates**

COPYRIGHT 2021, COUNTY OF SUFFOLK, N.Y.
Real Property Taxmap parcel linework used with permission of Suffolk County Real Property Tax Service Agency (R.P.T.S.A.). This rendering is a DRAFT MAP in that 1) the data displayed is an interagency or intra agency work produced for the purposes of identifying and correcting data. It is not a final agency determination. It is not statistical or factual compilation of data. In some cases correct data has been left out and questionable or inaccurate data has been exaggerated to help identify errors. In short, this is a DRAFT MAP produced in an effort to aid in the correction of data and is not held out as being complete or accurate in any way.
Excerpted from (FOIL) the provisions of the Freedom of Information Law (Public Officers Law Article 87 Section 84-90) by section 87.2(g)
This map is a compilation of data from:
1. The New York State Digital Orthographic Aerials
2. The Suffolk County Real Property Tax Map Parcel Line Work
3. The Suffolk County Real Property Tax Service GIS Base Map
4. Field GPS Locations and Verifications
5. Seagrass Source: NYSDEC Statewide seagrass map last revised July 11, 2018

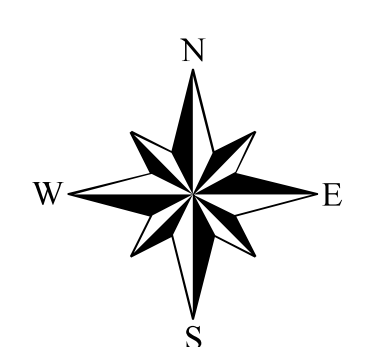

1 inch = 4,250 feet
1 inch = 0.8 miles

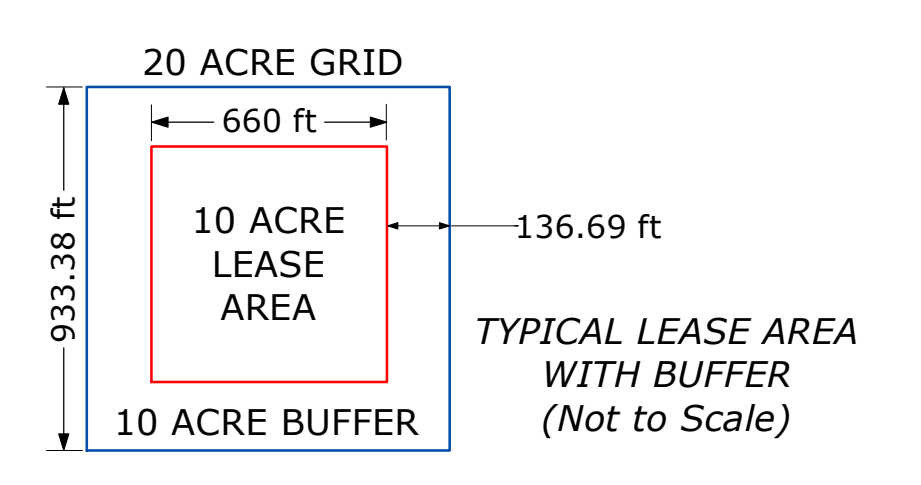
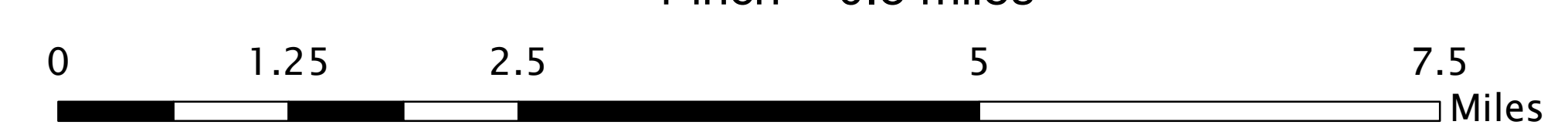

- LEGEND**
- 1000 ft HIGH WATER MARK BUFFER (AS PER NYS ECL 13-0302)
 - LEASE PROGRAM BOUNDARY (AS PER NYS ECL 13-0302)
 - TOWN BOUNDARY
 - SHELLFISH CULTIVATION ZONE (17,166 AC)
 - 10 ACRE LEASE AREA +
 - 10 ACRE LEASE BUFFER +
 - OYSTER GRANT (NUMBERED GR1 - GR65)
 - NYS OFFICE OF GENERAL SERVICES LEASE
 - VILLAGE
 - + Symbol to scale

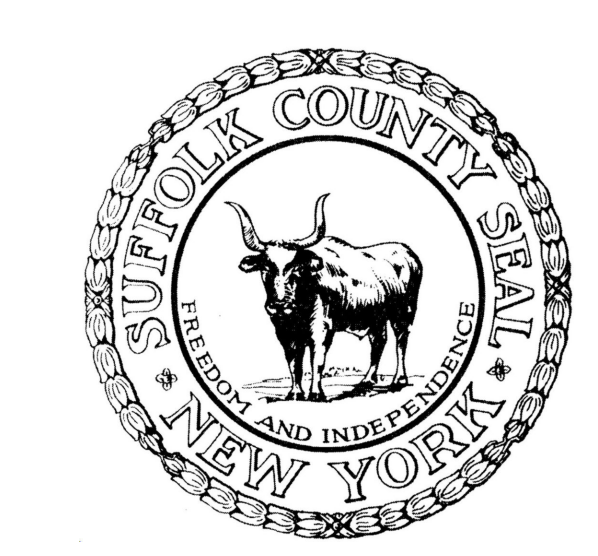

MAP 2
REVISED AQUACULTURE LEASE SITES
SUFFOLK COUNTY, NEW YORK
SUFFOLK COUNTY DEPARTMENT OF
ECONOMIC DEVELOPMENT AND PLANNING
DIVISION OF PLANNING AND ENVIRONMENT